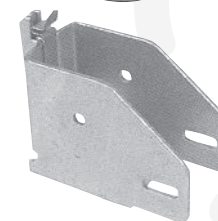
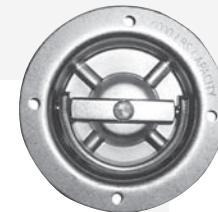
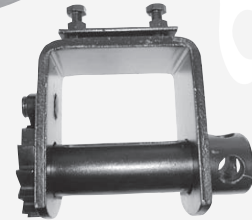
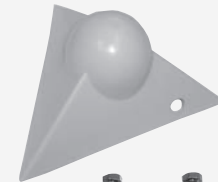
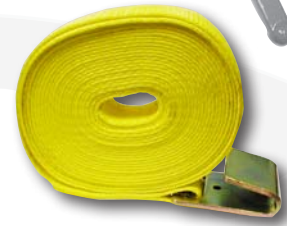

TABLE OF CONTENTS

CATEGORY	PAGES
FLATBED PRODUCTS	
INFORMATION & DEFINITIONS	4
WINCHES	5 - 6
WINCH STRAPS & ASSEMBLIES	7 - 8
WINCH BARS & TRACK	9
RATCHET STRAP ASSEMBLIES	10
WEB ACCESSORIES	11
BINDERS & TRANSPORT CHAIN	12
INTERIOR VAN PRODUCTS	
LOGISTIC STRAPS	13
LOGISTIC TRACK & FITTINGS	13
DECKING/SHORING BEAM PARTS	14
CARGO BARS	14
ROPE & LASHING RINGS	15
UTILITY	
UTILITY PARTS & ACCESSORIES	16
LIGHT DUTY STRAPS	16
HARDWARE	
ATTACHMENT HARDWARE	17
RATCHET STRAP HANDLES	17
PART-TO-PAGE REFERENCE	21 - 22
CROSS REFERENCE	23 - 26
WARRANTY POLICY	27



WINCHES

- Winches are marked with working load capacity 5,000 lbs.
- Breaking strength 15,000 lbs.
- Web slots are smooth ground to prevent web tear.
- Surfaces are finished with electro deposited paint.

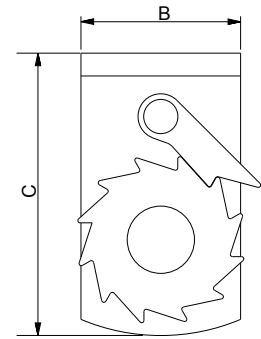
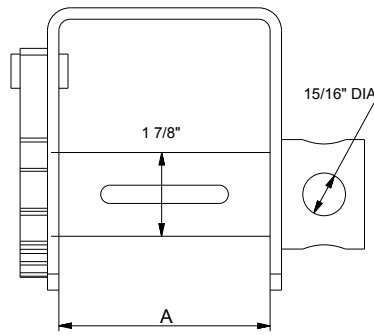

PN	DESCRIPTION	WEIGHT LBS.	A INTERNAL WIDTH	B FRAME DEPTH
UNDERMOUNT WELD ON WINCHES				
LC1	Standard - Stores 20' of Webbing	7.93	4.88"	3.54"
LC1B	Standard - 3 Bar Mandrel	14.81	6 1/2"	3 15/16"
LC1BOLT	Undermount Winch - Bolt On	14.81	6 1/2"	3 15/16"
LC1CW	Combination	10.09	7 5/32"	3"
LC1DC	Double Cap - Low Clearance Application	9.13	6 5/16"	3 1/2"
LC1S	Storable - Deep - Stores 30' of Webbing	8.97	4 7/8"	3 1/2"
UNDERMOUNT PORTABLE WINCHES W/ 2 SET SCREWS				
LC2	Standard - Stores 20' of Webbing	9.89	4 7/8"	3 1/2"
LC2CW	Portable Combination	8.36	6.496"	5.71"
LC2S	Storeable Deep - Stores 30' of Webbing	10.64	4 7/8"	3 1/2"
SIDE MOUNT WELD ON WINCHES				
LC3	Standard - Stores 10' of Webbing	9.15	4 7/8"	3 15/16"
LC3B	Standard - 3 Bar Mandral	13.33	6 1/2"	3 15/16"
LC3CW	Combination - Stores 30' of Webbing	10.76	7 1/4"	3 15/16"
LC3P	Low Profile - Side Mount - Stores 10' of Webbing	10.20	4 7/8"	3 15/16"
NOTCHED SLIDER WINCHES				
LC4	Standard - Stores 20' of Webbing	11.04	4 7/8"	3 15/16"
LC4F	Sliding Winch - OEM "FO" Style	9.17	4.88"	3.54"
LC4LC	Notched Slider Winch - Low Clearance	10.25	4.88"	5.98"
LC4LL	Double L Notched Slider Winch	7.89	4 7/8"	3 15/16"
LC4LL-CW	Double L Slider Winch - Combination	9.24	6.496"	6.3"
LC4LL-LC	Double L Slider Winch - Low Clearance	7.89	4 7/8"	3 15/16"
LC4LL-S	Double L Slider Winch - Storable	7.89	4 7/8"	3 15/16"
LC4S	Storable - Stores 30' of Webbing	11.64	4 7/8"	3 15/16"
LC4W	OEM Style "W" Slider Winch	9.81	4.88"	5.51"



LC1



LC2



LC3



LC4



LC4LL

CAUTION: When tightening or loosening winches, never release the winch bar until you are sure the pawl has fully engaged the sprocket teeth. The winch must be installed where the pawl can easily be seen.

WINCHES



LC6-3



LC8CW



LC9L



LC10L

PN	DESCRIPTION	WEIGHT LBS.	A INTERNAL WIDTH	B FRAME DEPTH
SPOOL WINCHES				
LC6-2	2" Spool	12.64	4 7/8"	3 1/2"
LC6-3	3" Spool	11.16	4 7/8"	3 1/2"
LC6-4	4" Spool	11.16	4 7/8"	3 1/2"
RECESSED BOX WINCH				
LC8CW	Combination	14.03	9 1/2"	4"
LASHING WINCHES				
LC9	Lashing Winch - (Hole)	3.41	2.13"	4.02"
LC9D	Double Hex Lashing Winch	3.87	2.13"	4.02"
LC9L	Left Hand - 2"	3.3	2 1/8"	2 15/16"
LC9R	Right Hand - 2"	3.3	2 1/8"	2 15/16"
CABLE WINCHES				
LC10L	End Mount, Left Hand	15.11	6 5/16"	3 15/16"
LC10R	End Mount, Right Hand	15.11	6 5/16"	3 15/16"

- Double hex drive, can be bolted or welded on one side.
- Breaking strength 11,000 lbs.
- Work load capacity 3,500 lbs.
- Meet or exceed all requirements of DOT, CHP and CVSA
- Specifications set forth by the Web Sling and Tiedown Association are met or surpassed.
- Work load capacity 3,500 lbs.

CAUTION: *When tightening or loosening winches, never release the winch bar until you are sure the pawl has fully engaged the sprocket teeth. The winch must be installed where the pawl can easily be seen.*

WINCH STRAPS

INFORMATION & DEFINITIONS

- **Flat Hooks:** By far the most popular end fitting in the industry. The flat hook attaches to the side rail of a flatbed trailer. Available for 2", 3" and 4" straps
- **Chain Anchors:** These consist of a delta ring with an 18" length of chain with hook. Typically used to tie down bulky, unwieldy equipment on a lowboy or flatbed. The equipment will have an eyebolt or ring attached to it just for that purpose. Can also be used to anchor into stake pockets.
- **D-Rings:** These are also called Delta Rings or V-Rings. They are used when you have a hook or a peg welded into a piece of equipment or the trailer.
- **Twisted Loop:** Used in situations similar to a D-ring, where you have a peg or a hook welded onto a piece of equipment, or on the trailer.
- **Wire Hooks:** Used where there is a D-ring slot, or hole in the equipment or trailer that you can fasten it to.
- **Flat Snap:** Often used where the fitting connects to a D-ring. Popular end fitting for car hauling.
- **Twisted Snaps:** Used in similar applications as the flat snap hook, except the 90° twist makes it easier to connect.

STRAP REQUIREMENTS

All straps are required to display a sewn in tag with the determined strap rating: Most tags post the strap's WLL - working load limit in pounds. The WLL is determined by the industry standard as required by the CVSA (Commercial Vehicle Safety Alliance) whereas the WLL rating is a maximum of 1/3 of the minimum breaking strength (MBS).

In order to make strap rating universal and simple, the CVSA designed the following tagging system:

- 4" Strap - 15,000 lbs. MBS - 5,000 lbs. WLL Tag
- 3" Strap - 15,000 lbs. MBS - 5,000 lbs. WLL Tag
- 2" Strap - 10,000 lbs. MBS - 3,333 lbs. WLL Tag
- Web tie down assemblies are to be identified with a visible marking or label within 18 inches from one end of the strap.
- The minimum information required on a strap label is the manufacturer or trademark of the final assembler, country of origin, and the Working Load Limit (WLL) in pounds and kilograms. Synthetic web tie downs should not be repaired or spliced for reuse at any time.

WINCH STRAPS

PN	SIZE	WLL	MBS
WINCH STRAP ASSEMBLIES WITH FLAT HOOK			
LCW227FH	2" x 27'	3333 lbs	10,000 lbs
LCW230FH	2" x 30'	3333 lbs	10,000 lbs
LCW235FH	2" x 35'	3333 lbs	10,000 lbs
LCW240FH	2" x 40'	3333 lbs	10,000 lbs
LCW275FH	2" x 75'	3335 lbs	10,000 lbs
LCW327FH	3" x 27'	5000 lbs	15,000 lbs
LCW330FH	3" x 30'	5000 lbs	15,000 lbs
LCW420FH	4" x 20'	5000 lbs	15,000 lbs
LCW427FH	4" x 27'	5000 lbs	15,000 lbs
LCW430FH	4" x 30'	5000 lbs	15,000 lbs
LCW430FH-RD	4" x 30' - Red	5000 lbs	15,000 lbs
LCW432FH	4" x 32'	5000 lbs	15,000 lbs
LCW435FH	4" x 35'	5000 lbs	15,000 lbs
LCW440FH	4" x 40'	5000 lbs	15,000 lbs
LCW445FH	4" x 45'	5000 lbs	15,000 lbs
LCW450FH	4" x 50'	5000 lbs	15,000 lbs
LCW460FH	4" x 60'	5500 lbs	16,500 lbs



All straps meet or exceed WSTDA, DOT, CHP and CVSA specifications and guidelines, and are made from resin coated polyester webbing for extended wear and durability.

WINCH STRAPS



LCW227DR



LCW430TL



LCW427WH



LCW430CA

PN	SIZE	WLL	MBS
WINCH STRAP ASSEMBLIES WITH D RING			
LCW227DR	2" x 27'	3333 lbs	10,000 lbs
LCW327DR	3" x 27'	5000 lbs	15,000 lbs
LCW420DR	4" x 20'	5500 lbs	16,500 lbs
LCW427DR	4" x 27'	6667 lbs	20,000 lbs
LCW430DR	4" x 30'	5000 lbs	20,000 lbs
LCW440DR	4" x 40'	5500 lbs	16,500 lbs
WINCH STRAP ASSEMBLIES WITH TWISTED LOOP			
LCW230TL	2" x 30'	3333 lbs	10,000 lbs
LCW430TL-BL	4" x 30' - Blue	6000 lbs	18,000 lbs
LCW430TL	4" x 30'	6000 lbs	18,000 lbs
LCW450TL	4" x 50'	5500 lbs	16,500 lbs
WINCH STRAP ASSEMBLIES WITH WIRE HOOK			
LCW227WH	2" x 27'	3333 lbs	10,000 lbs
LCW230WH	2" x 30'	3333 lbs	10,000 lbs
LCW327WH	3" x 27'	5000 lbs	15,000 lbs
LCW427WH	4" x 27'	6667 lbs	20,000 lbs
LCW430WH	4" x 30'	6667 lbs	20,000 lbs
LCW440WH	4" x 40'	6667 lbs	20,000 lbs
WINCH STRAP ASSEMBLIES WITH CHAIN ANCHOR			
LCW227CA	2" x 27'	3333 lbs	10,000 lbs
LCW327CA	3" x 27'	5000 lbs	15,000 lbs
LCW330CA	3" x 30'	5000 lbs	15,000 lbs
LCW427CA	4" x 27'	5400 lbs	16,200 lbs
LCW430CA	4" x 30'	5400 lbs	16,200 lbs
MISCELLANEOUS STRAPS & PARTS			
LC98-FH4	4" Flat Hook		
LCV220LE	2" X 20' - 18,000 lbs Reinforced Tow Strap w/Loop Ends		
LCV420LE	4" X 20' - 36,000 lbs Reinforced Tow Strap w/Loop Ends		
RS406H	4" x 6' Roll-Off Strap		

All straps meet or exceed WSTDA, DOT, CHP and CVSA specifications and guidelines, and are made from resin coated polyester webbing for extended wear and durability.

WINCH BARS & TRACK

PN	DESCRIPTION	WEIGHT
WINCH BARS		
LC12C	Standard Chrome	5.0 lbs
LC12P	Standard Painted	5.0 lbs
LC12CC	Box End - Combination - Chrome	6.5 lbs
LC12CP	Box End - Combination - Painted	6.5 lbs
LC12EC	Expanded End - Combination - Chrome	5.96 lbs
LC12EP	Expanded End - Combination - Painted	5.96 lbs
LC12R	Ratchet Winch Bar	6.6 lbs
<i>Tapered and angled at the end and are heat treated for added strength and durability.</i>		
WINCH TRACK		
LC13LL	Double Aluminum - 10' Length	34.1 lbs
LC13S	Steel 6' Length - Painted Black	37.93 lbs



LC12C



LC12CP



LC12CC

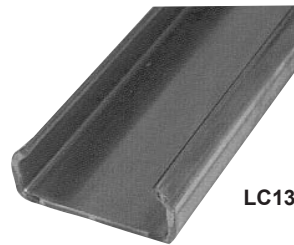

LC13S

RATCHET STRAP ASSEMBLIES



LCR230FH



LCR227FSH

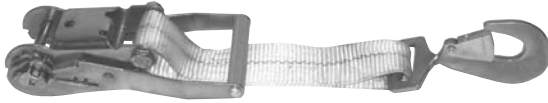

LCR227TSH



LCR227FH-SH



LCR227FH-SW

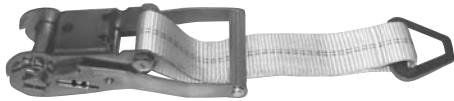

LCR227DR



LCR227WH-CAMO



LCR327WH



LCR227WH-SH



LCR327CA



LCR227GH

PN	SIZE	WLL	MBS
WITH FIXED END			
LCR218FE	2" x 18'	With Ratchet	
LCR418FE	4" x 18'	With Ratchet	
LCR418FENR	4" x 18'	Without Ratchet	
WITH FLAT HOOK & LONG WIDE HANDLE			
LCR227FH	2" x 27'	3333 lbs	10,000 lbs
LCR230FH	2" x 30'	3333 lbs	10,000 lbs
LCR232FH	2" x 32'	3333 lbs	10,000 lbs
LCR235FH	2" x 35'	3333 lbs	10,000 lbs
LCR240FH	2" x 40'	3333 lbs	10,000 lbs
LCR250FH	2" x 50'	3333 lbs	10,000 lbs
LCR327FH	3" x 27'	5000 lbs	15,000 lbs
LCR330FH	3" x 30'	5000 lbs	15,000 lbs
LCR427FH	4" x 27'	5000 lbs	15,000 lbs
LCR430FH	4" x 30'	5000 lbs	15,000 lbs
WITH FLAT SNAP HOOK			
LCR227FH-SH	2" x 27'	3335 lbs	10,000 lbs
LCR230FH-SH	2" x 30'	3335 lbs	10,000 lbs
WITH TWISTED SNAP HOOK & SHORT HANDLE			
LCR227TSH	2" x 27'	3333 lbs	10,000 lbs
LCR230TSH	2" x 30'	3333 lbs	10,000 lbs
WITH FLAT HOOK & STANDARD HANDLE			
LCR227FH-SH	2" x 27'	3333 lbs	10,000 lbs
LCR230FH-SH	2" x 30'	3333 lbs	10,000 lbs
WITH FLAT HOOK & SHORT WIDE HANDLE			
LCR227FH-SW	2" x 27'	3333 lbs	10,000 lbs
LCR230FH-SW	2" x 30'	3333 lbs	10,000 lbs
WITH D RING & LONG WIDE HANDLE			
LCR227DR	2" x 27'	3333 lbs	10,000 lbs
LCR427DR	4" x 27'	6666 lbs	20,000 lbs
LCR430DR	4" x 30'	6666 lbs	20,000 lbs
WITH WIRE HOOK & LONG WIDE HANDLE			
LCR227WH	2" x 27'	3333 lbs	10,000 lbs
LCR227WH-CAMO	2" x 27'	3333 lbs	10,000 lbs
LCR230WH	2" x 30'	3333 lbs	10,000 lbs
LCR327WH	3" x 27'	5000 lbs	15,000 lbs
LCR427WH	4" x 27'	6667 lbs	20,000 lbs
LCR430WH	4" x 30'	6667 lbs	20,000 lbs
WITH WIRE HOOK & STANDARD HANDLE			
LCR227WH-SH	2" x 27'	3333 lbs	10,000 lbs
LCR230WH-SH	2" x 30'	3333 lbs	10,000 lbs
WITH ANCHOR CHAIN & LONG WIDE HANDLE			
LCR227CA	2" x 27'	3333 lbs	10,000 lbs
LCR230CA	2" x 30'	3333 lbs	10,000 lbs
LCR327CA	3" x 27'	5000 lbs	15,000 lbs
LCR330CA	3" x 30'	5000 lbs	15,000 lbs
LCR430CA	4" x 30'	5400 lbs	16,200 lbs
WITH GRAB HOOK			
LCR227-GH	2" x 27'	3333 lbs	10,000 lbs
LCR230-GH	2" x 30'	3335 lbs	10,000 lbs

FLATBED PRODUCTS

WEB ACCESSORIES

PN	DESCRIPTION & USE
CORNER PROTECTORS	
LC15CCR	6" Steel, use with chain, cable or rope
LC15P	Plastic, use with 2" - 4" webbing
LC15-1PV	1" Plastic, use with 2" - 4" webbing
LC15-2S	Slotted steel, use with 2" webbing
LC15S	5" Steel, use with chain, cable, rope or webbing
LC15-NS	6" Steel, use with chain, cable, rope or webbing
LC15-SC	For use with chain
VEE BOARD	
LC15-4AV	4" Aluminum
WEBBING PROTECTOR	
LC15-4R	Rubber webbing protector for 3" or 4" straps
LC15-4W	4" Cordura web protector - 14" long
STRAP WINDER	
LC14	Steel winder for 2", 3" & 4" webbing
RUBBER ROPE	
LCH716M	Hollow rope - 1000' coil - 7/16" diameter
LCS38M	Solid rope - 1000' coil - 3/8" diameter
LCS716M	Solid rope - 1000' coil - 7/16" diameter
ROPE CLIPS	
WRCM-3	Malleable Wire Rope Clip - 3/16"
WRCM-6	Malleable Wire Rope Clip - 3/8"
WRCM-8	Malleable Wire Rope Clip - 1/2"
SJ HOOKS	
LCSJHOOK	Rubber rope hook - 100 per pack
LCSJHOOK-10	Rubber rope hook - 10 per pack
WEBBING	
LCWEB206-BLU	2" X 300', 6000 lbs - Blue
LCWEB212	2" X 300', 12000 lbs - Yellow



TARP STRAPS

PN	DESCRIPTION	STD. PK.
100% EPDM RUBBER WITH HOOKS		
TS10	10" Length, built up ends, attached hooks	25
TS15	15" Length, built up ends, attached hooks	25
TS21	21" Length, built up ends, attached hooks	25
TS31	31" Length, built up ends, attached hooks	25
TS41	41" Length, built up ends, attached hooks	25
TSHOOK	Replacement S Hook for tarp straps	100

- Rubber construction meets/exceeds ASTM standards
- Tensile strength 2558PSI
- Load at break 264.6 lbs.
- Elongation at 50 lbs. - 100%
- Elongation at break. - 500%
- Durometer 58 IRHD
- Stretch recovery 98.8%
- Low temperature -51° C / -59° F



NOTE: 10" Strap measures 9" at rest.

FLATBED PRODUCTS



LC20L-5

LC20R-5



LC18



LC70-38



LC70SHKL-12



CDC70-12



C70-516X20



CQL-6

BINDERS & TRANSPORT CHAIN

PN	SIZE	WLL	WEIGHT
LEVER LOAD BINDERS			
LC20L-5	5/16" - 3/8"	5400 lbs	8.0 lbs
LC20L5-ID	5/16" - 3/8" - Indirect	5400 lbs	8.0 lbs
LC20L-6	3/8" - 1/2"	9200 lbs	8.0 lbs
<i>Binders are forged and feature 360 degree swivel ends.</i>			
RATCHET LOAD BINDERS			
LC20R-4	1/4" - 5/16"	2,200 lbs	3.52 lbs
LC20R-5	5/16" - 3/8"	5,400 lbs	10.28 lbs
LC20R-6	3/8" - 1/2"	9,200 lbs	24.49 lbs
LC20R-8	1/2" - 5/8"	13,000 lbs	14.38 lbs
FLOOR CHAIN TIEDOWN			
LC18	Grade 70	4500 lbs	3.30 lbs
CLEVIS GRAB HOOKS			
LC70-12	1/2"	Grade 70	
LC70-38	3/8"	Grade 70	1.10 lbs
LC70-516	5/16"	Grade 70	.85 lbs
LC98GH	Grab Hook Assembly		
GR70 DOUBLE CLEVIS LINKS			
CDC70-12	GR70 Double Clevis Link - 7/16"-1/2"		
CDC70-38	GR70 Double Clevis Link- 3/8"		
CDC70-516	GR70 Double Clevis Link- 1/4"-5/16"		
GR70 CLEVIS SLIP HOOKS			
LC70SHKL-12	GR70 Clevis Slip Hook w/Latch - 1/2"		
LC70SHKL-14	GR70 Clevis Slip Hook w/Latch- 1/4"		
LC70SHKL-38	GR70 Clevis Slip Hook w/Latch - 3/8"		
LC70SHKL-516	GR70 Clevis Slip Hook w/Latch - 5/16"		
CHAIN ASSEMBLIES WITH CLEVIS HOOKS			
C43-38X20	3/8" x 20' - GR43	4700 lbs	20.50 lbs
C70-12X20	1/2" x 20' - Binder	4700 lbs	20.50 lbs
C70-12X25	1/2" x 25' - Binder	4700 lbs	20.50 lbs
C70-516X20	5/16" x 20'	4700 lbs	20.50 lbs
C70-516X25	5/16" x 25'	4700 lbs	26.90 lbs
C70-38X20	3/8" x 20'	6600 lbs	28.66 lbs
C70-38X25	3/8" x 25'	6600 lbs	35.27 lbs
QUICK LINKS			
CQL-4	Quick Link - 1/4"		
CQL-5	Quick Link - 5/16"		
CQL-6	Quick Link - 3/8"		
CQL-8	Quick Link - 1/2"		
LC98-QL-6	Stainless Steel Quick Link - 3/8"		

- Chain is Grade 70 long link
- Gold chromate finish for ease of identification and protection
- Meets all specifications and standards of DOT, CVSA and CHP

INTERIOR VAN

LOGISTIC STRAPS

PN	DESCRIPTION	WEIGHT
LOGISTIC STRAP WITH CAM BUCKLE		
LCC212-E	2" X 12' w/Spring E fitting, WLL 917 lbs, MBS 2750 lbs - yellow	3.2 lbs
LCC216-BF	2" X 16' w/Butterfly F fitting, WLL 417 lbs, MBS 1250 lbs - gray	3.3 lbs
LCC216-E	2" X 16' w/Spring E fitting, WLL 917 lbs, MBS 2750 lbs - gray	3.3 lbs
LCC220-E	2" X 20' w/Spring E fitting, WLL 917 lbs, MBS 2750 lbs - blue	3.4 lbs
LCC212-3P	2" X 12' w/3 piece E fitting, WLL 917 lbs, MBS 2750 lbs - yellow	1.9 lbs
LOGISTIC STRAP WITH RATCHET		
LCL212-E	2" X 12' w/spring E fitting, WLL 1000 lbs, MBS 3000 lbs - yellow	3.2 lbs
LCL216-E	2" X 16' w/spring E fitting, WLL 1000 lbs, MBS 3000 lbs - gray	3.3 lbs
LCL220-E	2" X 20' w/spring E fitting, WLL 1000 lbs, MBS 3000 lbs - blue	3.4 lbs
LCL216-3P	2" X 16' w/3 piece E fitting, WLL 1000 lbs, MBS 3000 lbs - gray	3.3 lbs
LCL212-W	2" X 12' w/wire hooks, WLL 1000 lbs, MBS 3000 lbs - yellow	3.2 lbs
LCL216-MP	2" X 16' multi-purpose, has wire hooks & spring E fittings, WLL 1000 lbs, MBS 3000 lbs - gray	3.2 lbs
LCL220-MP	2" X 20' multi-purpose w/wire hooks & spring E fittings, WLL 1000 lbs, MBS 3000 lbs - blue	3.2 lbs



LCC216-E



LCC216-BF



LCL220-E

TRACK & FITTINGS

PN	DESCRIPTION	WEIGHT
E TRACK SERIES		
LCE2HG	2' Galvanized - horizontal	3.1 lbs
LCE5HP	5' Painted - horizontal	7.5 lbs
LCE10HG	10' Galvanized - horizontal	16.09 lbs
LCE10HP	10' Green powder coated paint - horizontal	16.11 lbs
LCE10VP	10' Green powder coated paint - vertical	16.11 lbs
<i>Made from 12 gauge 50,000 psi high strength steel.</i>		
E TRACK SERIES FITTINGS		
LCE10-2D	Spring fitting with 2" D ring - 2000 lb WLL	.33 lbs
LCE10-1C	Spring fitting with ring	.51 lbs
E TRACK SERIES ROPE TIE OFFS		
LCT6-E	6" w/spring E fitting - WLL 1000 lbs - MBS 3000 lbs	.40 lbs
LCT6-3P	6" w/3 piece E fitting - WLL 1000 lbs - MBS 3000 lbs	.30 lbs
F TRACK SERIES		
LCF10G	Galvanized, length 10'	7.52 lbs
<i>Made from 16 gauge steel with .75" horizontal holes. Logistics track can be attached via welding and/or with rivets and screws.</i>		



LCE10HG

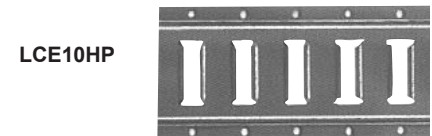

LCE10HP

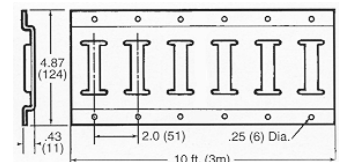

LCF10G

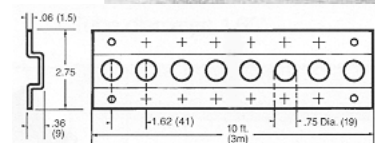

LCE10-2D

LCE10-1C

LCT6-E

LCT6-3P

INTERIOR VAN PRODUCTS

DECKING / SHORING BEAMS & PARTS

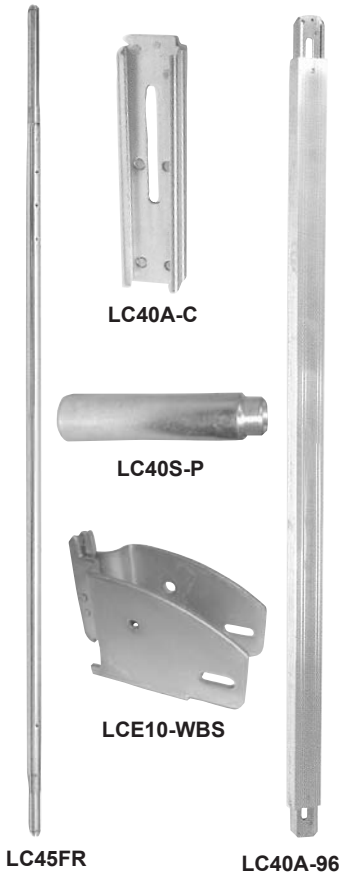

PN	DESCRIPTION	WEIGHT
DECKING / SHORING BEAMS		
LC40A-96	Aluminum, 85.7" - 96.6" adjustable range, decking WLL 2200 lbs, shoring WLL 2000 lbs	16.0 lbs
LC40A-102	Aluminum, 92.1" - 102.9" adjustable range, decking WLL 2200 lbs, shoring WLL 2000 lbs	18.0 lbs
LC40A-96HD	Aluminum, 85.7" - 96.6" adjustable range, decking WLL 3000 lbs, shoring WLL 2500 lbs	23.5 lbs
LC40A-102HD	Aluminum, 92.1" - 102.9" adjustable range, decking WLL 3000 lbs, shoring WLL 2500 lbs	25.5 lbs
LC40S-102	Steel, 92.1" - 102.9" adjustable range, decking WLL 1500 lbs, shoring WLL 1500 lbs	27.0 lbs
LC45FR	Steel F shoring bar, round, adjustable range to 105", F size .75", WLL 500 lbs	15.0 lbs
BEAM REPLACEMENT PARTS		
LC40A-C	Aluminum channel	
LC40S-C	Steel channel	
LC40S-P	Steel attaching pin	
LCE10-WBS	Standard wood beam socket, use with 2" X 6" lumber	99 lbs.
NOTE: Working load limits of lumber varies widely.		

CARGO BARS & ACCESSORIES

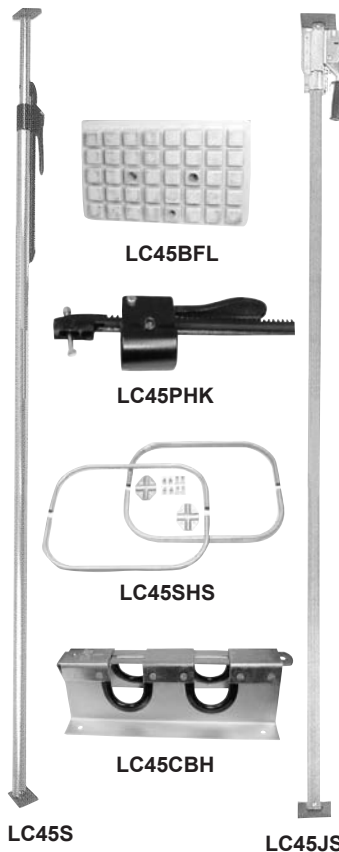

PN	DESCRIPTION	WEIGHT
PADDLE HANDLE CARGO BARS		
LC45S	Steel one piece w/2" X 4" bolt-on feet, 89" - 105" extension	89.0 lbs
LC45S-60	Steel one piece 60" Cargo Bar	9.6 lbs
LC45A	Aluminum one piece w/2" X 4" bolt-on feet, 89" - 105"	89.0 lbs
JACK CARGO BARS		
LC45JR	1 Piece with 4" X 4" bolt-on feet, round, 90" - 105" extension	18.0 lbs
LC45JS	1 Piece with 4" X 4" bolt-on feet, square, 90" - 105" extension	18.0 lbs
LC45JSH	1 Piece with 4" X 4" bolt-on feet, with welded hoops, 90" - 105" extension	25.0 lbs
Bars expand to fit securely without putting excess pressure on trailer walls. Cargo bars are not given load capacities because trailer sidewalls vary.		
CARGO BAR REPLACEMENT PARTS		
LC45BFL	2" X 4" Bolt-on feet, large tube	
LC45BFL-4X4	4" X 4" Bolt-on feet, large tube	
LC45BFS	2" X 4" Bolt-on feet, small tube	
LC45BFS-4x4	4" X 4" Bolt-on feet, small tube	
LC45PHK	Paddle handle kits	
LC45SHS	Steel cargo bar hoop set w/brackets & hardware	
LC45AHS	Aluminum cargo bar hoop set w/brackets & hardware	
CARGO BAR HOLDER		
LC45CBH	Holds two cargo bars w/locking mechanism, sizes 2" X 4" and 4" X 4"	5.5 lbs
Constructed of rust resistant galvanized steel.		

INTERIOR VAN PRODUCTS

ROPE & LASHING RINGS / PINS

PN	DESCRIPTION	MBS
ROPE RINGS - RECESSED		
LC19-20	Recessed surface mount	500 lbs
LC19-22	Recessed 3" diameter mounting hole in 1/4" thick material	500 lbs
LC19-30	Recessed rotating	5000 lbs
ROPE RINGS - STANDARD		
LC19-60	Light duty, 1 1/2" wide ring	700 lbs
LC19-62	2" Wide D Ring	3000 lbs
PAN FITTING RING		
LC19-26	Requires 3 5/8" diameter mounting hole in 7/8" thick material	500 lbs
FORGED RINGS		
B38	3 3/8" Wide - 1/2" diameter, with bracket	11,781 lbs
B40	4 1/4" Wide - 5/8" diameter, with bracket	18,390 lbs
B46	4 1/2" Wide - 3/4" diameter, with bracket	26,500 lbs
B50	5" Wide - 1" diameter, with bracket	46,760 lbs
B5055	5" Wide - 1" diameter w/bracket, lower half is angled 55°	46,760 lbs
ANCHOR SHACKLE SCREW PINS		
CSS-8	1/2" Anchor Shackle Screw Pin	
CSS-10	5/8" Anchor Shackle Screw Pin	
CSSF-12	3/4" Anchor Shackle Screw Pin	
CSSF-6	3/8" Anchor Shackle Screw Pin	
CSSF-8	1/2" Anchor Shackle Screw Pin	
COLD SHUT		
CCS-4	Cold Shut - 1/4"	
CCS-5	Cold Shut - 5/16"	

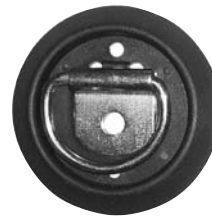

LC19-20



LC19-22



LC19-30



LC19-60



LC19-26



LC19-62



CSS-8



CSS-4

- Rope and lashing rings are tie down points in the interior of the trailer
- Working load limits are equal to 1/3 of maximum breaking strength



B38



B50



B40



B5055



B46

UTILITY REPLACEMENT PARTS & ACCESSORIES



LC19-52



LCR2-18FE



LCR2-18FENR



LC16



LC16HD



LCU309



LCU412



LCU115-4



LCU515

PN	DESCRIPTION
TIE-DOWN ANCHOR POINTS	
LC19-46	Stainless steel, 2 piece retail pack
LC19-52	Economy, eye bolt
<i>Tie down pins mount easily and securely into stake holes and lock down and pop up when needed.</i>	
RATCHET STRAP ENDS W/FLAT HOOKS	
LCR2-18FE	2" X 18" Fixed end with ratchet
LCR2-18FENR	2" X 18" Fixed end without ratchet
LCR3-18FE	3" X 18" Fixed end with ratchet
LCR4-18FE	4" X 18" Fixed end with ratchet
LCR4-18FENR	4" X 18" Fixed end without ratchet
COIL RACKS	
LC16	Light duty, 33" long, 2 3/4" wide, 2 1/2" tall
LC16HD	Heavy duty, 38 1/2" long, 3 3/4" wide, 2 1/2" tall
<i>One piece construction for extra support.</i>	
1" HEAVY DUTY RATCHET STRAPS	
LCU306	6' Strap with vinyl coated S hooks
LCU309	9' Strap with vinyl coated S hooks
LCU312	12' Strap with vinyl coated S hooks
LCU315	15' Strap with vinyl coated S hooks
LCU315-1*	15' Strap with vinyl coated S hooks - 1 piece retail pack
LCU320	20' Strap with vinyl coated S hooks
LCU412	12' Strap with wire hook and D rings
LCU415	15' Strap with wire hook and D rings
LCU420	20' Strap with wire hook and D rings
1" LIGHT DUTY RATCHET STRAPS	
LCU106	6' Strap with vinyl coated S hooks
LCU109	9' Strap with vinyl coated S hooks
LCU112	12' Strap with vinyl coated S hooks
LCU115	15' Strap with vinyl coated S hooks
LCU115-4*	15' Strap with vinyl coated S hooks - 4 piece retail pack
LCU212	12' Strap with wire hook and D rings
LCU220	12' Strap with wire hook and D rings
1" LIGHT DUTY CAM BUCKLE STRAPS	
LCU506	6' Strap with vinyl coated S hooks
LCU515	15' Strap with vinyl coated S hooks
LCU615	15' Strap with wire hook and D rings

*Abrasion resistant webbing is black.

ATTACHMENT HARDWARE PARTS

PN	SIZE	MBS	WLL
SPRING E FITTING			
LC98-E	2"	6000 lbs	2000 lbs
ZINC PLATED S HOOK			
LC98-S	2"	1300 lbs	433 lbs
CHAIN ANCHORS & GRAB HOOK ASSEMBLY			
LC98-CA4	18" w/4" D-Ring	16200 lbs	5400 lbs
LC98-GH	2" Grab Hook	16200 lbs	5400 lbs
DELTA RINGS			
LC98-DR2	2"	11000 lbs	3666 lbs
LC98-DR3	3"	20000 lbs	6666 lbs
LC98-DR4	4"	20000 lbs	6666 lbs
WIRE D RING			
LC98-D2	2"	5500 lbs	1833 lbs
CAM BUCKLE - STANDARD			
LC99-CB2	2"	2500 lbs	833 lbs
WRENCH O-RING			
LC98-R2	2"	10000 lbs	3333 lbs
RTJ CLUSTER HOOK			
LC98-RTJ	2"	11732 lbs	3911 lbs
FLAT HOOK			
LC98-FH4	4"	16000 lbs	5333 lbs
STAINLESS STEEL QUICK LINKS			
LC98-QL-4	1/4"	7940 lbs	2647 lbs
LC98-QL-5	5/16"	10000 lbs	3333 lbs
LC98-QL-6	3/8"	15200 lbs	5067 lbs
LOGISTIC HANDLE			
LC99-RH2L	2"	4400 lbs	1467 lbs
STANDARD HANDLE WITH HOOK			
LC99-RH2SHK	2"	6600 lbs	2200 lbs
LONG WIDE HANDLE			
LC99-RH2	2"	11000 lbs	3666 lbs
LC99-RH3	3"	22000 lbs	7333 lbs
LC99-RH4	4"	22000 lbs	7333 lbs
STANDARD HANDLE			
LC99-RH2SH	2"	11000 lbs	4400 lbs
SHORT WIDE HANDLE			
LC99-RH2SW	2"	11000 lbs	3666 lbs
STANDARD WIDE HANDLE			
LC99-RH2WO	2"	11000 lbs	3666 lbs



LC98-E



LC98-S



LC98-GH



LC98-D2



LC98-DR3



LC99-CB2



LC98-R2



LC98-QL5



LC98-RTJ



LC98-FH4



LC99-RH2L



LC99-RH2SHK



LC99-RH2

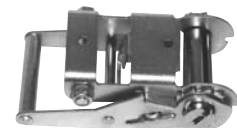

LC99-RH2SH

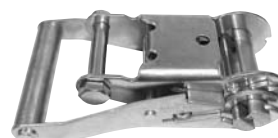

LC99-RH2SW



LC99-RH2WO