

PILLOW BLOCK

PN	Shaft Diam	Mount Bolts C to C	Overall Height	Base to Shaft Center
PB16	1"	4 1/8"	2 25/32"	1 7/16"
PB20	1 1/4"	5"	3 2 1/32"	1 7/8"
PB24	1 1/2"	5 13/32"	3 27/32"	1 5/16"

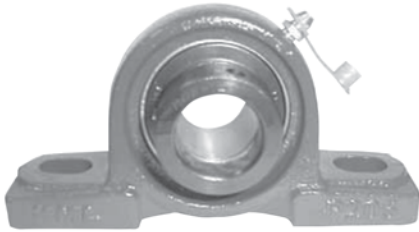

PILOT BEARINGS

PN	PN
203FF	305SS
205FF	306DD
205SS	306FF
206FF	306SS
206SS	306SSL
207FF	306VV
209DD	
212SLV	
305DD	



306FF



306VV

U-JOINT ACCESSORY

PN	Description
P6.5-70-18X	1/2 round strap kit, 1710-1810



WASHERS/SPACERS/KEYS

PN	Description
14749	M/S Spacer 11-12-14-15 - Black
16463	Input D/G Bearing Spacer Various Applications
4302398	M/S Washer 918 Series
4303603	M/S Washer 918 Series
4304614	M/S Key Replaces 4300890
4304615	M/S Key Replaces 4300120



14749

AIR VALVES

PN	Description
A-3546	Range Valve
A-4487	3-Position, O/D 1/2" - 13 Thread
A-4490	3-Position, U/D 1/2" - 13 Thread
A-4491	2-Position, O/D 1/2" - 13 Thread
A-4688	Slave Valve Assembly - Late
A-4740	Filter Regulator Assembly
A-5000	Slave Valve Assembly - Late
A-6909	Shift Knob - 9 & 10 Speed
A-6910	Shift Valve
A-6913	Shift Knob - 13 Speed Replaces A-4900
A-6915	Shift Knob - 15 Speed & LL Box Replaces A-5015
A-6918	Shift Knob - 18 Speed Replaces A-5013
16743	Air Regulator - Early
19974	Splitter Insert Valve

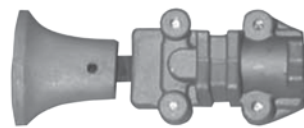

A-3546



A-4487



A-6909



A-6913



A-4740

REPAIR KITS

PN	Description
K-1447	O-Ring Kit-Range/Reducer Splitter 13-15 Speeds
K-1450	O-Ring Kit-Range 9-10-13-15 Speeds
K-1935	Slave Repair Kit, Late, A5000
K-2256	Output Seal Kit, Various Applications
K-2262	Output Seal & Slinger Kit Various Applications
K-3494	Replacement Kit, Sliding Clutch

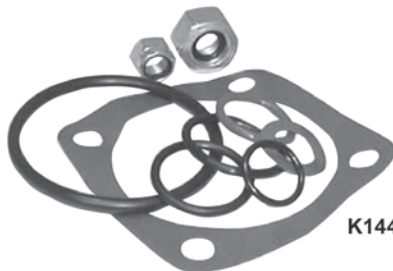

K1447



19974

OIL FILLER CAPS

PN	Size	Application
41085P	1¼"	Ford New Holland
44004P	2"	Cummins, Mack w/Chain
44027P	1¾"	Detroit, T-Handle
44050P	1¼"	Caterpillar, Cummins, Navistar, T-Handle
44052P	2½"	John Deere
44097P	1⅝"	Mack
44098P	2"	Caterpillar, Cummins, Detroit, Mack, Navistar - T Handle
44141P	1"	Caterpillar, Detroit
44165P	1½"	Caterpillar, Cummins, Detroit, Navistar
44209P	1⅝"	Caterpillar, Navistar
44352P	2"	Univeral - Knob Style
44401P	1⅝"	Caterpillar
44402P	2¼"	Cummins
44901P	1½"	Caterpillar - w/Chain



FUEL TANK CAPS

PN	Description	Cross
40246P	3 ⅞", w/Chain - Navistar	---
40546P	3" w/Chain - Kenworth	---
41312	4 ¼" - Caterpillar/Freightliner	---
44117P	3" - Caterpillar/Freightliner/Kenworth	---
44425P	3 ⅞", w/Chain - Kenworth	---
FTA-C-01	4" Fuel Cap 8 NPSM	600180
FTA-C-02	2" Locking Fuel Cap Reefer & International	---
FTA-C-04	4" Locking Fuel Cap	600169-6
FTA-C-12	Freightliner M2 Cap Aluminum Assembly M-2, 2.5-8	---
FTA-C-13	2" Locking Fuel Cap Freightliner M2	600150
FTA-C-19	Volvo, International, Mack Fuel Cap Aluminum Assembly	600184
FTA-C-51C	3" Chrome Locking Fuel Cap 8NPSL	600183-6
FTA-C-67-P	Locking Peterbilt Fuel Cap	11-04859-200
FTA-C-69	Volvo, Mack, Navistar Locking Fuel Cap	---
FTA-C-81	Kenworth Cap 3.5-5.5 NS Full Aluminum Assembly	---
FTA-C-90	4" Fuel Cap 8NPSL 12" Chain 8.35" Bail	600168
FTA-C-92	Freightliner (1/4 Turn) Cap Aluminum Assembly	600148
FTA-C-93	Freightliner Cascadia 1/4 Turn Locking Aluminum Assembly	600149
FTA-C-97	Kenworth Locking Fuel Cap	---
FTA-C-98	Reefer & International MD Cap Aluminum Assembly	---

FUEL TANK ANTI-SIPHONS

PN	Application
FTA-187-75	Reefer & Med. Duty International 7.5" w/1.875" Fill Neck - Fits 1 7/8"
FTA-225-95	Freightliner 9.5" w/2.25" Fill Neck
FTA-25-675	Volvo, Mack, International 6.75" w/2.5" Fill Neck
FTA-25-95	9.5" Kenworth w/2.5" Fill Neck
FTA-27	2" X 7.5" Medium Duty Fill Neck M2 Freightliner
FTA-27K	2" X 7.5" Medium Duty Fill Neck Kenworth
FTA-37	Volvo, Mack, International 7" w/3" Fill Neck
FTA-49	4" X 9" Heavy Duty Fill Neck

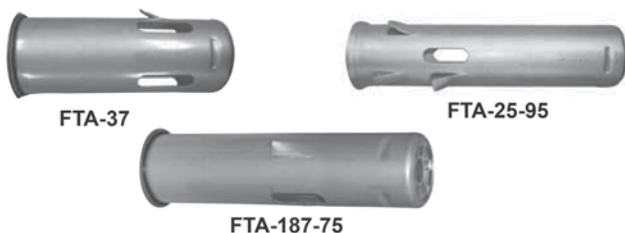

DIPSTICKS

PN	Description
40761P	3 1/32" x 48", .32" x .25" Spring Steel Blade
40764P	3 1/32" x 84"
40767P	1 1/32" x 48"
40770P	1 1/32" x 84", .32" x .25" Spring Steel Blade
41420P	3 1/32" x 84", .20" x .187" Spring Steel Blade

CLAMPS

STANDARD T-BOLT



PN	SAE Size	Min		Max	
		Inch	mm	Inch	mm
TB-125	*	1.25	32	1.39	35
TB-138	*	1.38	35	1.52	40
TB-150	*	1.5	38	1.64	43
TB-163	*	1.63	41	1.88	48
TB-175	28	1.75	45	2	51
TB-188	32	1.88	48	2.19	56
TB-200	36	2	51	2.31	59
TB-213	40	2.13	54	2.44	62
TB-225	44	2.25	57	2.56	65
TB-238	48	2.38	60	2.69	68
TB-250	52	2.5	64	2.81	71
TB-263	56	2.63	67	2.94	75
TB-275	60	2.75	70	3.06	78
TB-288	64	2.88	73	3.19	81
TB-300	68	3	76	3.31	84
TB-313	72	3.13	79	3.44	87
TB-325	76	3.25	83	3.56	91
TB-338	80	3.38	86	3.69	94
TB-350	84	3.5	89	3.81	97
TB-363	88	3.63	92	3.94	100
TB-375	92	3.75	95	4.06	103
TB-400	100	4	102	4.31	110
TB-406	102	4.06	103	4.38	111
TB-425	108	4.25	108	4.56	116
TB-450	116	4.5	114	4.81	122
TB-456	118	4.56	116	4.88	124
TB-475	124	4.75	121	5.06	129
TB-500	132	5	127	5.31	135
TB-525	140	5.25	133	5.56	141
TB-550	148	5.5	140	5.81	148
TB-575	156	5.75	146	6.06	154
TB-600	164	6	152	6.31	160
TB-625	172	6.25	159	6.56	167
TB-650	180	6.5	165	6.81	173
TB-700	196	7	178	7.31	186
TB-725	204	7.25	184	7.56	192
TB-750	212	7.5	191	7.81	198
TB-800	228	8	203	8.31	211
TB-825	236	8.25	210	8.56	218
TB-850	244	8.5	216	8.81	224

APPLICATIONS INCLUDE:

- Turbo
- Diesel Exhaust
- Air Brakes
- Marine Exhaust
- Diaphragm Bodies
- Sanitary Systems
- Dairy Industry
- Pumps
- Bleed Air Systems
- Flanged Tanks
- Cannisters
- Filter Bags
- Sump Pump
- Lab Equipment

*Performance engineered for long term durability
and manufactured to the highest quality standards.*

CLAMPS

SPRING LOADED T-BOLT

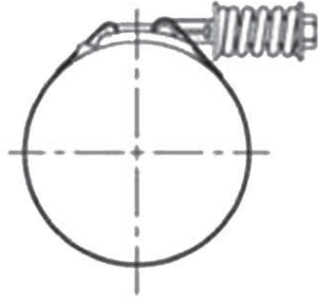
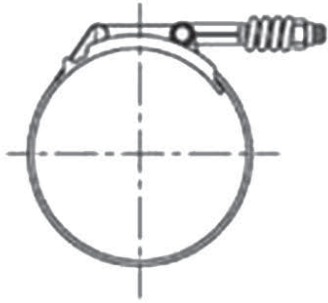

Standard Duty - Small Spring B9226

Heavy Duty - Large Spring B9224

PN	Hvy. Duty PN	SAE Size	Min		Max	BREEZE Cross Std. Duty PN B9226	BREEZE Cross Hvy. Duty PN B9224
			Inch	mm	Inch		
—	—	40	2.13	54	2.44	-213	-213
B9226-0225B	—	44	2.25	57	2.56	-225	-225
—	—	48	2.38	60	2.69	-238	-238
B9226-0250	—	52	2.5	64	2.81	-250	-250
B9226-0263	—	56	2.63	67	2.94	-263	-263
B9226-0275B	B9224-0275B	60	2.75	70	3.06	-275	-275
—	—	64	2.88	73	3.19	-288	-288
—	—	68	3	76	3.31	-300	-300
B9226-0306	B9224-0306	70	3.06	78	3.38	-306	-306
—	—	72	3.13	79	3.44	-313	-313
B9226-0325	—	76	3.25	83	3.56	-325	-325
B9226-0338	—	80	3.38	86	3.69	-338	-338
—	—	84	3.5	89	3.81	-350	-350
B9226-0356	B9224-0356	86	3.56	91	3.88	-356	-356
—	B9224-0363	88	3.63	92	3.94	-363	-363
B9226-0375	B9224-0375	92	3.75	95	4.06	-375	-375
B9226-0406	B9224-0406	102	4.06	103	4.38	-406	-406
B9226-0413B	B9224-0413	104	4.13	105	4.44	-413	-413
B9226-0425B	B9224-0425	108	4.25	108	4.56	-425	-425
—	—	116	4.5	114	4.81	-450	-450
B9226-0456	B9224-0456	118	4.56	116	4.88	-456	-456
—	—	132	5	127	5.31	-500	-500
B9226-0525	—	140	5.25	133	5.56	-525	-525
B9226-0550B	—	148	5.5	140	5.81	-550	-550
—	—	156	5.75	146	6.06	-575	-575
—	—	164	6	152	6.31	-600	-600
—	—	172	6.25	159	6.56	-625	-625
—	—	180	6.5	165	6.81	-650	-650
—	—	196	7	178	7.31	-700	-700
—	—	204	7.25	184	7.56	-725	-725
—	—	212	7.5	191	7.81	-750	-750

CLAMPS

CONSTANT TORQUE® HEAVY DUTY

Heavy duty construction for use on large diameter applications-torque rated 50-125 in/lbs. 5/8" (15.8 mm) bandwidth.

Carbon Screw PN	All Stainless Steel PN	SAE Size	EFFECTIVE DIAMETER RANGE			
			Min		Max	
			Inch	mm	Inch	mm
CT 200 L	CT 200 L SS	212	1-1/4	32	2-1/8	54
CT 250 L	CT 250 L SS	262	1-3/4	45	2-5/8	67
CT 300 L	CT 300 L SS	312	2-1/4	57	3-1/8	79
CT 350 L	CT 350 L SS	362	2-3/4	70	3-5/8	92
CT 400 L	CT 400 L SS	412	3-1/4	83	4-1/8	105
CT 450 L	CT 450 L SS	462	3-3/4	95	4-5/8	118
CT 500 L	CT 500 L SS	512	4-1/4	108	5-1/8	130
CT 550 L	CT 550 L SS	562	4-3/4	121	5-5/8	143
CT 600 L	CT 600 L SS	612	5-1/4	133	6-1/8	156
CT 650 L	CT 650 L SS	662	5-3/4	146	6-5/8	168
CT 700 L	CT 700 L SS	712	6-1/4	159	7-1/8	181
CT 750 L	CT 750 L SS	762	6-3/4	172	7-5/8	194
CT 800 L	CT 800 L SS	812	7-1/4	184	8-1/8	206
CT 850 L	CT 850 L SS	862	7-3/4	197	8-5/8	219
CT 900 L	CT 900 L SS	912	8-1/4	210	9-1/8	232



Constant Torque® clamps automatically increase/decrease in diameter as the system expands and contracts. These clamps are ideal if experiencing leakage or rupture problems due to "cold flow" or changes in environmental and operational temperatures.



CONSTANT TORQUE® AERO SEAL

AERO-SEAL construction, all stainless steel for use on small diameter applications 9/16" (14.2 mm) bandwidth.

PN	SAE Size	EFFECTIVE DIAMETER RANGE			
		Min		Max	
		Inch	mm	Inch	mm
CT-9410	10	9/16	14	1-1/16	27
CT-9412	12	11/16	17	1-1/4	32
CT-9416	16	13/16	21	1-1/2	38
CT-9420	20	13/16	21	1-3/4	44
CT-9424	24	1-1/16	27	2	51
CT-9428	28	1-5/16	33	2-1/4	57
CT-9432	32	1-9/16	40	2-1/2	64
CT-9436	36	1-13/16	46	2-3/4	70
CT-9440	40	2-1/16	52	3	76
CT-9444	44	2-5/16	59	3-1/4	83
CT-9448	48	2-9/16	65	3-1/2	89
CT-9452	52	2-13/16	71	3-3/4	95



CLAMPS

HI-TORQUE® HEAVY DUTY BREEZE

Super strong worm-gear clamp - incredible torquing drive (150+ in/lbs), sealing pressure and vibration resistance.

5/8" BAND			EFFECTIVE DIAMETER RANGE			
410 Stainless Steel PN	Stainless Steel PN	SAE Size	Min		Max	
			Inch	mm	Inch	mm
HTM-175	HTM-175 SP	—	1	25	1-3/4	45
HTM-200	HTM-200 SP	212	1-1/4	32	2-1/8	54
HTM-250	HTM-250 SP	262	1-3/4	45	2-5/8	67
HTM-300	HTM-300 SP	312	2-1/4	57	3-1/8	79
HTM-350	HTM-350 SP	362	2-3/4	70	3-5/8	92
HTM-400	HTM-400 SP	412	3-1/4	83	4-1/8	105
HTM-450	HTM-450 SP	462	3-3/4	95	4-5/8	118
HTM-500	HTM-500 SP	512	4-1/4	108	5-1/8	130
HTM-550	HTM-550 SP	562	4-3/4	121	5-5/8	143
HTM-600	HTM-600 SP	612	5-1/4	133	6-1/8	156
HTM-650	HTM-650 SP	662	5-3/4	146	6-5/8	168
HTM-700	HTM-700 SP	712	6-1/4	159	7-1/8	181
HTM-750	HTM-750 SP	762	6-3/4	172	7-5/8	194
HTM-800	HTM-800 SP	812	7-1/4	184	8-1/8	206
HTM-850	HTM-850 SP	862	7-3/4	197	8-5/8	219
HTM-900	HTM-900 SP	912	8-1/4	210	9-1/8	232
EXTENDED RANGE SIZES						
HP-2	HP-2 SP	—	1-1/4	32	2-5/8	67
HP-3	HP-3 SP	—	2-1/8	54	4-1/8	105
HP-4	HP-4 SP	—	4	102	6-1/8	156
HP-5	HP-5 SP	—	6-1/8	156	9-1/8	232



Standard Hi-Torque

Also available in 316 stainless steel as special order



Hi-Torque With Liner

CLAMPS

V-BAND HEAVY DUTY

Performance engineered for long term durability and manufactured to the highest quality standards.

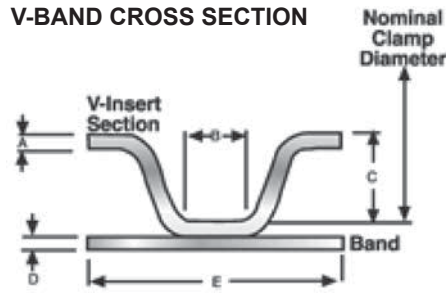

Power Products PN	Application	Nom. Diam.	V-INSERT SECTIONS			BANDS		Breeze Cross
			A	B	C	D	E	
VBC250DD	Detroit 8.2T	2.88"	0.06	0.207	0.281	0.035	0.75	VT10288
VBC275C	Cummins B	3.21"	0.05	0.262	0.141	0.035	0.75	VT10321
—	—	3.50"	0.08	0.207	0.281	0.04	0.875	VT10350
VBC300DD	Detroit 6V	3.82"	0.077	0.207	0.281	0.04	0.875	VT10382
VBC300C	Cummins V903 Man	3.88"	0.05	0.4	0.281	0.04	0.875	VT10388
VBC400N	Detroit 8.2N	4.06"	0.077	0.239	0.281	0.05	0.875	VT10406
VBC350C	Cummins C	4.13"	0.05	0.262	0.141	0.035	0.75	VT10413
VBC350CAT	CAT 3208T	4.19"	0.05	0.4	0.281	0.04	0.875	VT10419
VBC350NAV	Nav DT466 91	4.25"	0.05	0.4	0.281	0.04	0.875	VT10425
—	—	4.50"	0.077	0.207	0.281	0.04	0.875	VT10450-A
VBC350DD	Detroit 8V	4.50"	0.05	0.262	0.141	0.035	0.75	VT10450
VBC400M	Most Mack 6 Cyl	4.61"	0.05	0.156	0.218	0.035	0.75	VT10461
—	—	4.69"	0.05	0.4	0.281	0.04	0.875	VT10469
VBC400C	Cummins L10/CAT 3176T	4.75"	0.05	0.4	0.281	0.04	0.875	VT10475
VBC400T	Detroit 8.2T	4.75"	0.077	0.158	0.31	0.04	0.875	VT10475-A
VBC400DD	Detroit 6V	4.81"	0.077	0.207	0.281	0.04	0.875	VT10481
—	—	4.91"	0.04	0.293	0.296	0.05	0.875	VT10491
VBC400E	Mack	4.94"	0.06	0.181	0.281	0.035	0.75	VT10494
—	—	5.10"	0.05	0.262	0.141	0.035	0.75	VT10510
VBC478DD	Var Detroit	5.25"	0.05	0.262	0.141	0.035	0.75	VT10525
—	—	5.30"	0.05	0.262	0.141	0.035	0.75	VT10530
—	—	5.65"	0.05	0.262	0.141	0.035	0.75	VT10565
VBC500T	Detroit 8V	5.81"	0.077	0.207	0.281	0.062	0.875	VT10581
VBC500C	Cummins/CAT/Detroit	5.88"	0.05	0.4	0.281	0.04	0.875	VT10588
—	—	5.88"	0.05	0.4	0.281	—	—	VT10588-1
VBC500D	Detroit 8V	5.92"	0.09	0.293	0.296	0.05	0.875	VT10592
—	—	6.88"	0.06	0.4	0.281	0.04	0.875	VT10688
—	—	8.08"	0.05	0.262	0.141	0.035	0.75	VT10808

CLAMPS

GENERAL PURPOSE



Plated Hex Screw PN	410 Hex Stainless Steel Screw PN	SAE Size	EFFECTIVE DIAMETER RANGE			
			Min		Max	
			Inch	mm	Inch	mm
62006	64006	6	7/16	11	25/32	20
62008	64008	8	1/2	13	29/32	23
62010	64010	10	9/16	14	1-1/16	27
62012	64012	12	11/16	17	1-1/4	32
62016	64016	16	13/16	21	1-1/2	38
62020	64020	20	13/16	21	1-3/4	44
62024	64024	24	1-1/16	27	2	51
62028	64028	28	1-5/16	33	2-1/4	57
62032	64032	32	1-9/16	40	2-1/2	64
62036	64036	36	1-13/16	46	2-3/4	70
62040	64040	40	2-1/16	52	3	76
62044	64044	44	2-5/16	59	3-1/4	83
62048	64048	48	2-9/16	65	3-1/2	89
62052	64052	52	2-13/16	71	3-3/4	95
62056	64056	56	3-1/16	78	4	102
62060	64060	60	3-5/16	84	4-1/4	108
62064	64064	64	3-9/16	91	4-1/2	114
62072	64072	72	1-7/8	48	5	127
62080	64080	80	2-1/2	64	5-1/2	140
62088	64088	88	3-1/8	79	6	152
62096	64096	96	3-5/8	92	6-1/2	165
62104	64104	104	4-1/8	105	7	178



General purpose automotive and industrial clamps. High strength 4-piece lock construction exceeds all SAE requirements. Use for all standard clamp applications.

ENGINE - CLAMPS

MINI CLAMPS



5/16" BAND					EFFECTIVE DIAMETER RANGE			
Plated Hex Screw PN	410 Hex Stainless Steel Screw PN	300 Hex Stainless Steel Screw PN	All 316 Stainless Steel PN	SAE Size	Min		Max	
					Inch	mm	Inch	mm
3504	3604	3704	3804	4	7//32	5.6	5/8	16
3506	3606	3706	3806	6	7/16	11	25/32	20
3508	3608	3708	3808	8	1/2	13	29/32	23
3510	3610	3710	3810	10	9/16	14	1-1/16	27
3512	3612	3712	—	12	11/16	17	1-1/4	32
3516	3616	3716	—	16	15/16	24	1-1/2	38
3520	3620	3720	—	20	1-3/16	30	1-3/4	44
3524	3624	3724	—	24	1-7/16	37	2	51
3528	3628	3728	—	28	1-11/16	43	2-1/4	57
3532	3632	3732	—	32	1-15/16	49	2-1/2	64

Lightweight and streamlined for small diameter applications, such as air and fuel lines. Allows for installation in tight fitting or difficult to reach areas. Creates high sealing pressure with only 10 to 15 in/lbs of installation torque.



CLAMPS

LINER



Band extension provides inner protective liner to protect soft hose (silicone and others) from damage caused by extrusion or shearing.

Plated Hex Screw PN	410 Hex Screw Stainless Steel PN	SAE Size	EFFECTIVE DIAMETER RANGE				Breeze Cross Plated Hex Screw PN	Breeze Cross 410 Hex Screw Stainless Steel PN
			Inch	mm	Inch	mm		
9206H	9406H	6	7/16	11	25/32	20	9206	9406
9208H	9408H	8	1/2	13	29/32	23	9208	9408
9210H	9410H	10	9/16	14	1-1/16	27	9210	9410
9212H	9412H	12	11/16	17	1-1/4	32	9212	9412
9216H	9416H	16	13/16	21	1-1/2	38	9216	9416
9220H	9420H	20	13/16	21	1-3/4	44	9220	9420
9224H	9424H	24	1-1/16	27	2	51	9224	9424
9228H	9428H	28	1-5/16	33	2-1/4	57	9228	9428
9232H	9432H	32	1-9/16	40	2-1/2	64	9232	9432
9236H	9436H	36	1-13/16	46	2-3/4	70	9236	9436
9240H	9440H	40	2-1/16	52	3	76	9240	9440
9244H	9444H	44	2-5/16	59	3-1/4	83	9244	9444
9248H	9448H	48	2-9/16	65	3-1/2	89	9248	9448
9252H	9452H	52	2-13/16	71	3-3/4	95	9252	9452
9256H	9456H	56	3-1/16	78	4	102	9256	9456
9260H	—	60	3-5/16	84	4-1/4	108	9260	9460
9264H	—	64	3-9/16	91	4-1/2	114	9264	9464
9272H	—	72	4-1/8	48	5	127	9272	9472
9280H	—	80	4-5/8	64	5-1/2	140	9280	9480
—	—	88	5-1/8	79	6	152	9288	9488
—	—	96	5-5/8	92	6-1/2	165	9296	9496
—	—	104	6-1/8	105	7	178	92104	94104



RUBBER HOSE HEATER - KOOL BLU HIGH TEMP

PN	Hose ID In Inches	PSI
KB81050-50	1/2"	250
KB81062-50*	5/8"	250
KB81075-50*	3/4"	200
KB81087-50*	7/8"	200
KB81100-50*	1"	175
KB81125-50	1 1/4"	175

*Also available in 300' rolls.



*Premium EPDM
-40° to +300° F
50 Foot Rolls

SILICONE HOSE RADIATOR

PN	Size
70-038	3/8"
70-050	1/2"
70-075	3/4"
70-088	7/8"
70-100	1"
70-112	1 1/8"
70-125	1 1/4"
70-131	1 5/16"
70-138	1 3/8"
70-150	1 1/2"
70-162	1 5/8"
70-175	1 3/4"
70-187	1 7/8"
70-200	2"
70-212	2 1/8"
70-225	2 1/4"
70-238	2 3/8"
70-250	2 1/2"
70-262	2 5/8"
70-275	2 3/4"
70-287	2 7/8"
70-300	3"
70-325	3 1/4"
70-350	3 1/2"
70-400	4"
70-450	4 1/2"
70-500	5"
70-550	5 1/2"



RADIATOR HOSE

PN	Size
GPC075	3/4"
GPC088	7/8"
GPC100	1"
GPC112	1 1/8"
GPC125	1 1/4"
GPC138	1 3/8"
GPC150	1 1/2"
GPC162	1 5/8"
GPC175	1 3/4"
GPC188	1 7/8"
GPC200	2"
GPC212	2 1/8"
GPC225	2 1/4"
GPC238	2 3/8"
GPC250	2 1/2"
GPC262	2 5/8"
GPC275	2 3/4"
GPC288	2 7/8"
GPC300	3"
GPC325	3 1/4"
GPC350	3 1/2"
GPC400	4"

3-ply, meets SAE J20R1.
500 W in 3 ft. lengths only.



- Oil and weather resistant rubber cover.
- Used for air, water or fuel.
- Recommended temperature range -40° F to +212° F.
- Standard pack 50 ft.



HEATER

PN	Size
HEATER HOSE - 25 FT ROLLS	
80-025	1/4"
80-038	3/8"
80-050	1/2"
80-062	5/8"
80-075	3/4"
80-100	1"



Also available in
50' & 100' rolls and
250' reels.

PUSH-ON HOSE

PN	Size	Working Pressure	Minimum Burst Pressure
PH404-50	1/4"	300PSI	1200PSI
PH406-50	3/8"	300PSI	1200PSI
PH408-50	1/2"	300PSI	1200PSI
PH410-50	5/8"	300PSI	1200PSI

ELBOW REDUCERS

PN	Description
RE40X30	90° - 4" ID - 3" ID
RE50X40	90° - 5" ID - 4" ID
RE55X50	90° - 5½" ID - 5" ID
RE60X50	90° - 6" ID - 5" ID
RE60X55	90° - 6" ID - 5½" ID
RE70X50	90° - 7" ID - 5" ID
RE70X55	90° - 7" ID - 5½" ID
RE70X60	90° - 7" ID - 6" ID
RE70X60-45	45° - 7" ID - 6" ID
RE80X70	90° - 8" ID - 7" ID

Use standard T-bolt or torque clamps. Heavy duty rubber minimizes vibration and intake noise. Resists punctures and tears.



RE40X30

RE70X60-45

RUBBER AIR INTAKE INSERTS

PN	Size
N30X20	3" OD, 2" ID
N40X30	4" OD, 3" ID
N45X40	4½" OD, 4" ID
N50X40	5" OD, 4" ID
N55X40	5½" OD, 4" ID
N60X50	6" OD, 5" ID
N60X55	6" OD, 5½" ID
N70X60	7" OD, 6" ID



N30X20

N70X60

SILICONE ELBOWS

PN	ID	Legs	Radius
90-200MK	2"	6" X 6"	4"
90-225MK2	2 1/4"	6" X 6"	2 1/4"
90-250MK2	2 1/2"	6" X 6"	2 1/4"
90-300MK1	3"	6" X 6"	4"
90-300MK2	3"	6" X 6"	3"



90-200MK

TS Series

AIR INTAKE - SILICONE SILICONE BELLOWS - CAC

PN	ID	Length	Type
CSB30	3"	6"	Cold
CSB35	3 1/2"	6"	Cold
CSB40	4"	6"	Cold
CSB40X8	4"	8"	Cold
CSB45	4 1/2"	6"	Cold
HSB30	3"	6"	Hot
HSB35	3 1/2"	6"	Hot
HSB40	4"	6"	Hot
HSB40X8	4"	8"	Hot
HSB45	4 1/2"	6"	Hot
HSB45X8	4 1/2"	8"	Hot



CSB/HSB Series

TURBO SLEEVES

PN	ID	Length
TS275X350	2 3/4"	3 1/2"
TS300BULK	3"	36"
TS338X350	3 3/8"	3 1/2"
TS336X600	3 3/8"	6"
TS350BULK	3 1/2"	36"
TS400BULK	4"	36"

- CSB Series made from silicone/polyester material.
- HSB Series made from silicone/nomex material.
- Wire reinforced.

AIR INTAKE - RUBBER HUMP HOSE/REDUCERS

PN	Description
HH30	3" ID, Length 5 1/4"
HH30X25	3" ID - 2 1/2" ID, Length 4 1/2"
HH35	3 1/2" ID, Length 5 1/4"
HH35X30	3 1/2" ID - 3" ID, Length 5 1/4"
HH40	4" ID, Length 5 1/4"
HH40X30	4" ID - 3" ID, Length 5 1/4"
HH45	4 1/2" ID, Length 6"
HH45X40	4 1/2" ID - 4" ID, Length 6"
HH50	5" ID, Length 6"
HH50X40	5" ID - 4" ID, Length 5 3/4"
HH55	5 1/2" ID, Length 6"
HH55X50	5 1/2" ID - 5" ID, Length 6"
HH60	6" ID, Length 7"
HH60X50	6" ID - 5" ID, Length 6"
HH60X55	6" ID - 5 1/2" ID, Length 6 1/2"
HH70	7" ID, Length 6 1/2"
HH70X50	7" ID - 5" ID, Length 7"
HH70X55	7" ID - 5 1/2" ID, Length 7"
HH70X60	7" ID - 6" ID, Length 5 1/2"
HH80	8" ID, Length 5"
HH80X60	8" ID - 6" ID, Length 6"
HH80X70	8" ID - 7" ID, Length 6"



HH40X30



HH60X55

ELBOWS

PN	Description
RE30	90° - 3" ID
RE30-45	45° - 3" ID
RE35	90° - 3 1/2" ID
RE35-45	45° - 3 1/2" ID
RE40	90° - 4" ID
RE40-45	45° - 4" ID
RE45	90° - 4" ID
RE45-45	45° - 4 1/2" ID
RE50	90° - 5" ID
RE50-45	45° - 5" ID
RE55	90° - 5 1/2" ID
RE55-45	45° - 5 1/2" ID
RE60	90° - 6" ID
RE60-45	45° - 6" ID
RE70	90° - 7" ID
RE70-45	45° - 7" ID



RE30



RE55

INLET CAPS

PN	Fits OD	Height	Hood Diam.	Finish
H000471	4 1/2"	4 7/8"	11 1/2"	Black
H000472	4"	5"	11 1/2"	Black
H000605	5"	5 3/4"	16"	Black
H000606	6"	5 3/4"	16"	Black
H000607	7"	5 3/4"	16"	Black
H001053	8"	4 1/16"	16"	Black
H001948	6"	5 1/16"	16"	Chrome



H000606



H001948

Inlet caps are plastic.

INLET HOODS

PN	Size
H001654	7"
H001660	6"

*Stack mounted, overcab.
Mounting clamps included.*



H001654

INTERNAL PARTS

FLYWHEELS

PN	Description
P1821915C91	Navistar 14" DT466E



FLYWHEEL HOUSINGS

PN	Description
P3036005	IH, Kenworth, Freightliner White, Peterbilt
P3036011	Cummins Replacement Double Drilled

SOLENOIDS

PN	Description
1115556P	Solenoid 40MT, 12V
1115559P	Solenoid 40 MT, 24V
1115593P	Solenoid 42MT, 12V
1115595P	Solenoid 42MT, 24V
1115609P	Solenoid 37MT, 12V
1119879P	Starter Solenoid 40MT/50MT, 12V Early



1115593P



1119879P

SOLENOID SWITCHES

PN	VOLT	DUTY	TERMINALS	BRACKET	GROUND	COLE HERSEE CROSS	POLLAK CROSS
EL000200	12	Cont.	4	Flat	—	24059	52-307
EL000201*	12	Cont.	4	Flat	—	24143	—
EL000202	12	Cont.	3	Flat	Y	24106	52-312
EL000208	12	Cont.	3	Curved	Y	24082	—
EL000212	24	Cont.	4	Flat	—	24063	52-324
EL000213*	24	Cont.	4	Flat	—	24144	—
EL000220	12	Intermit.	4	Flat	—	24047	—
EL000222	12	Intermit.	3	Flat	Y	24037	52-303



EL000200



EL000208

*150A/300A

ALTERNATOR PULLEYS

PN	Description
24-1101	3/8" V - 2.62" OD - .670 Bore
24-1500	1/2" V - 3.12" OD - .875 Bore
24-1501	1/2" V - 3.5" OD - .875 Bore
24-2500	1/2" VV3.31" OD - .875 Bore



24-1500

FUEL LINE

PN	Description	Std. Pack
FL14-25	1/4" x 25', SAEJ30	25
FL38-25	3/8" x 25', SAEJ30	25
FL56-25	5/16" x 25', SAEJ30	25